

Spare parts list

Edition 20111028



Valid for serial no. 035-xxx-xxxx

Ordering no.	Denomination	Notes	Max Speed
0334 333 880	A6 Slide	Setting lenght = 60 mm	70cm/min
0334 333 881	A6 Slide	Setting lenght = 120 mm	70cm/min
0334 333 882	A6 Slide	Setting lenght = 180 mm	70cm/min
0334 333 883	A6 Slide	Setting lenght = 240 mm	70cm/min
0334 333 884	A6 Slide	Setting lenght = 300 mm	70cm/min
0334 333 885	A6 Slide	Setting lenght = 420 mm	70cm/min
0334 333 886	A6 Slide	Setting lenght = 540 mm	70cm/min
0334 333 887	A6 Slide	Setting lenght = 730 mm	70cm/min
0334 333 888	A6 Slide	Setting lenght = 1030 mm	70cm/min
0334 333 924	A6 Slide	Setting lenght = 300 mm	330 cm/min
0334 333 940	A6 Slide	Setting lenght = 60 mm *)	70cm/min
0334 333 941	A6 Slide	Setting lenght = 120 mm *)	70cm/min
0334 333 942	A6 Slide	Setting lenght = 180 mm *)	70cm/min
0334 333 943	A6 Slide	Setting lenght = 240 mm *)	70cm/min
0334 333 944	A6 Slide	Setting lenght = 300 mm *)	70cm/min
0334 333 945	A6 Slide	Setting lenght = 420 mm *)	70cm/min
0334 333 946	A6 Slide	Setting lenght = 540 mm *)	70cm/min
0459 839 055	Spare parts list		

*) *Optical pulse generator*

Spare parts are to be ordered through the nearest ESAB agency. Kindly indicate type of unit, serial number, denominations and ordering numbers according to the spare parts list.

Maintenance and repair work should be performed by an experienced person, and electrical work only by a trained electrician. Use only recommended spare parts.

Rights reserved to alter specifications without notice.

Slide

L= Setting lenght

Item	L=60	L=120	L=180	L=240	L=300	Ordering no.	Denomination	Notes
	880	881	882	883	884	0334 333	A6 Slide	
101	1	1	1	1	1	0461 221 001	End washer	
102	2	-	-	-	-	0334 323 001	Steel shaft	L=242.5
	-	2	-	-	-	0334 323 002	Steel shaft	L=302.5
	-	-	2	-	-	0334 323 003	Steel shaft	L=362.5
	-	-	-	2	-	0334 323 004	Steel shaft	L=422.5
	-	-	-	-	2	0334 323 005	Steel shaft	L=482.5
103	4	4	4	4	4	0334 337 001	Ball bushing open	2 sealed
104	1	1	1	1	1	0334 331 880	Runner for slide	
105	8	8	8	8	8	0190 509 321	Stop screw	M5x6
106	1	-	-	-	-	0334 332 001	Ball screw and nut	L216
	-	1	-	-	-	0334 332 002	Ball screw and nut	L276
	-	-	1	-	-	0334 332 003	Ball screw and nut	L336
	-	-	-	1	-	0334 332 004	Ball screw and nut	L396
	-	-	-	-	1	0334 332 005	Ball screw and nut	L392.5
107	2	2	-	-	-	0334 325 001	Bellow stearing	
108	2	2	-	-	-	0333 441 002	Telescopic bellows	D30/20
	-	-	2	2	2	0156 726 003	Telescopic bellows	D40/20
109	1	1	1	1	1	0334 324 001	Bellow stearing	D=20
110	1	1	1	1	1	0154 457 002	Ball bearing cap	
111	1	1	1	1	1	0190 531 201	Bearing	SKF 3201
112	2	2	2	2	2	0443 719 001	Sign	
113	2	2	2	2	2	0334 472 001	Warning sign	
114	1	1	1	1	1	0417 699 002	Clamp	
115	1	1	1	1	1	0334 322 001	Geared motor	24V, 110rpm
116	1	1	1	1	1	0334 321 001	Washer	Cover plate
117	1	1	1	1	1	0461 223 001	Motor bracket	
118	1	1	1	1	1	0215 701 007	Circlip	D10
119	2	2	2	2	2	0215 701 209	Flat wedge	3x3x14
120	1	1	1	1	1	0334 328 002	Toothed pulley	z=19
121	1	1	1	1	1	0334 330 880	Compression washer complete	
122	1	1	1	1	1	0334 327 001	Friction ring	
123	1	1	1	1	1	0334 328 001	Toothed pulley	z=30
124	2	2	2	2	2	0219 504 411	Spring washer	D31.5 / 16x1.2
125	1	1	1	1	1	0334 342 001	Cog belt	L=400 / 80 T
126	1	1	1	1	1	0334 320 001	Belt guard	
127	1	1	1	1	1	0334 329 001	Friction pin	

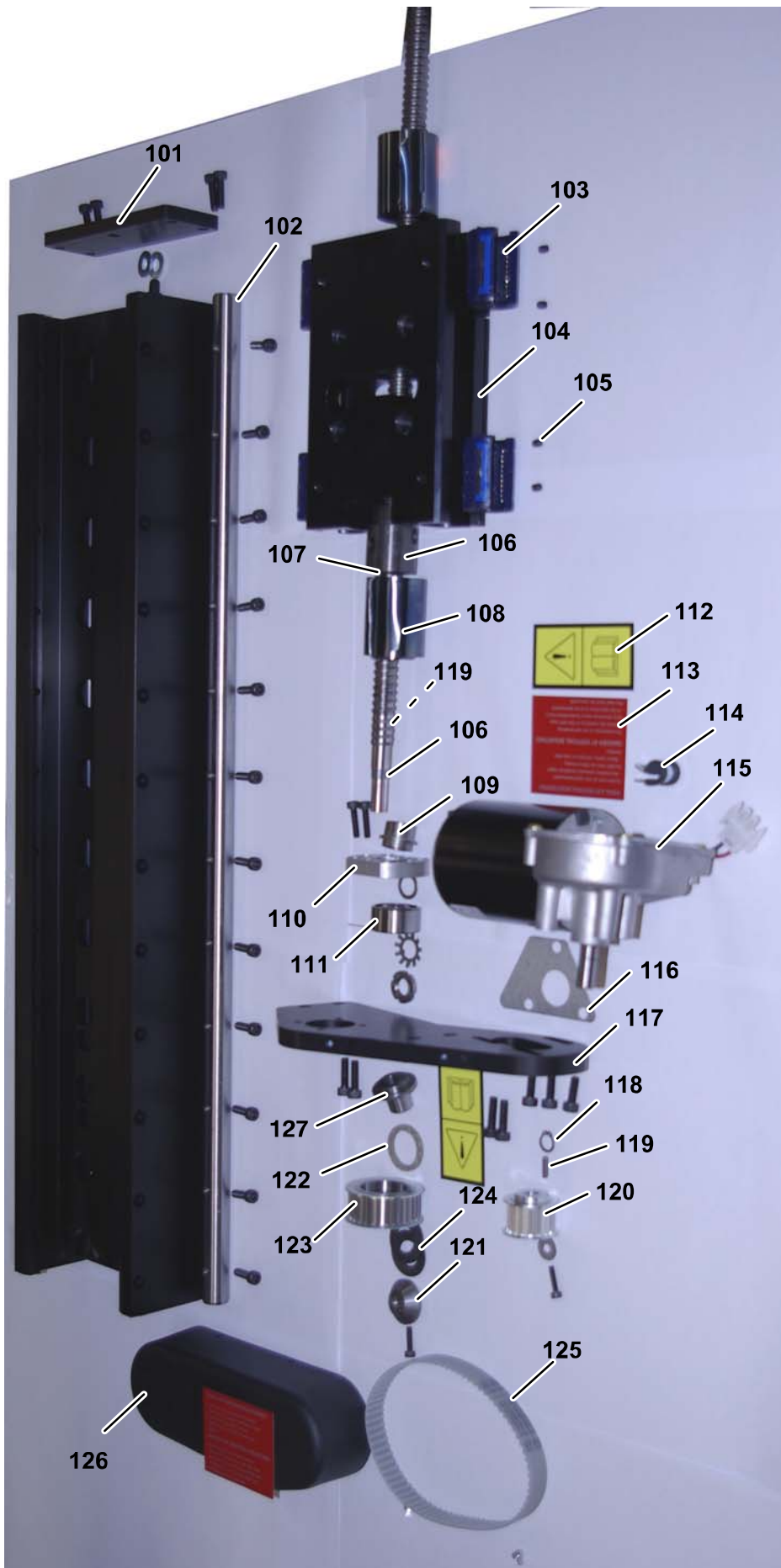

Slide

L= Setting lenght

Item	L=420	L=540	L=730	L=1030	L=300	Ordering no.	Denomination	Notes
	885	886	887	888	924	0334 333	A6 Slide	
201	1	1	1	1	1	0461 221 001	End washer	
202	2	-	-	-	-	0334 323 006	Steel shaft	L=602.5
	-	2	-	-	-	0334 323 007	Steel shaft	L=722.5
	-	-	2	-	-	0334 323 008	Steel shaft	L=962.5
	-	-	-	2	-	0334 323 009	Steel shaft	L=1322.5
	-	-	-	-	2	0334 323 005	Steel shaft	L=482.5
203	4	4	4	4	4	0334 337 001	Ball bushing open	2 sealed
204	1	1	1	1	1	0334 331 880	Runner for slide	
205	8	8	8	8	8	0190 509 321	Stop screw	M5x6
206	1	-	-	-	-	0334 332 006	Ball screw and nut	L576
	-	1	-	-	-	0334 332 007	Ball screw and nut	L633.5
	-	-	1	-	-	0334 332 008	Ball screw and nut	L1006
	-	-	-	1	-	0334 332 009	Ball screw and nut	L1366
	-	-	-	-	1	0334 332 005	Ball screw and nut	L392.5
208	2	2	2	4	2	0156 726 003	Telescopic bellows	D30/20
209	1	1	-	-	1	0334 324 001	Bellow steering	D=20
210	1	1	1	1	1	0154 457 002	Ball bearing cap	
211	1	1	1	1	1	0190 531 201	Bearing	SKF 3201
212	2	2	2	2	2	0443 719 001	Sign	
213	2	2	2	2	2	0334 472 001	Warning sign	
214	1	1	1	1	1	0417 699 002	Clamp	
215	1	1	1	1	-	0334 322 001	Geared motor	24V, 110rpm
	-	-	-	-	1	0334 322 002	Geared motor	24V, 200rpm
216	1	1	1	1	1	0334 321 001	Washer	Cover plate
217	1	1	1	1	1	0461 223 001	Motor bracket	
218	1	1	1	1	1	0215 701 007	Circlip	D10
219	2	2	2	2	2	0215 701 209	Flat wedge	3x3x14
220	1	1	1	1	1	0334 328 002	Toothed pulley	z=19
221	1	1	1	1	1	0334 330 880	Compression washer complete	
222	1	1	1	1	1	0334 327 001	Friction ring	
223	1	1	1	1	1	0334 328 001	Toothed pulley	z=30
224	2	2	2	2	2	0219 504 411	Spring washer	D31.5 / 16x1.2
225	1	1	1	1	1	0334 342 001	Cog belt	L=400 / 80 T
226	1	1	1	1	1	0334 320 001	Belt guard	
227	1	1	1	1	1	0334 329 001	Friction pin	

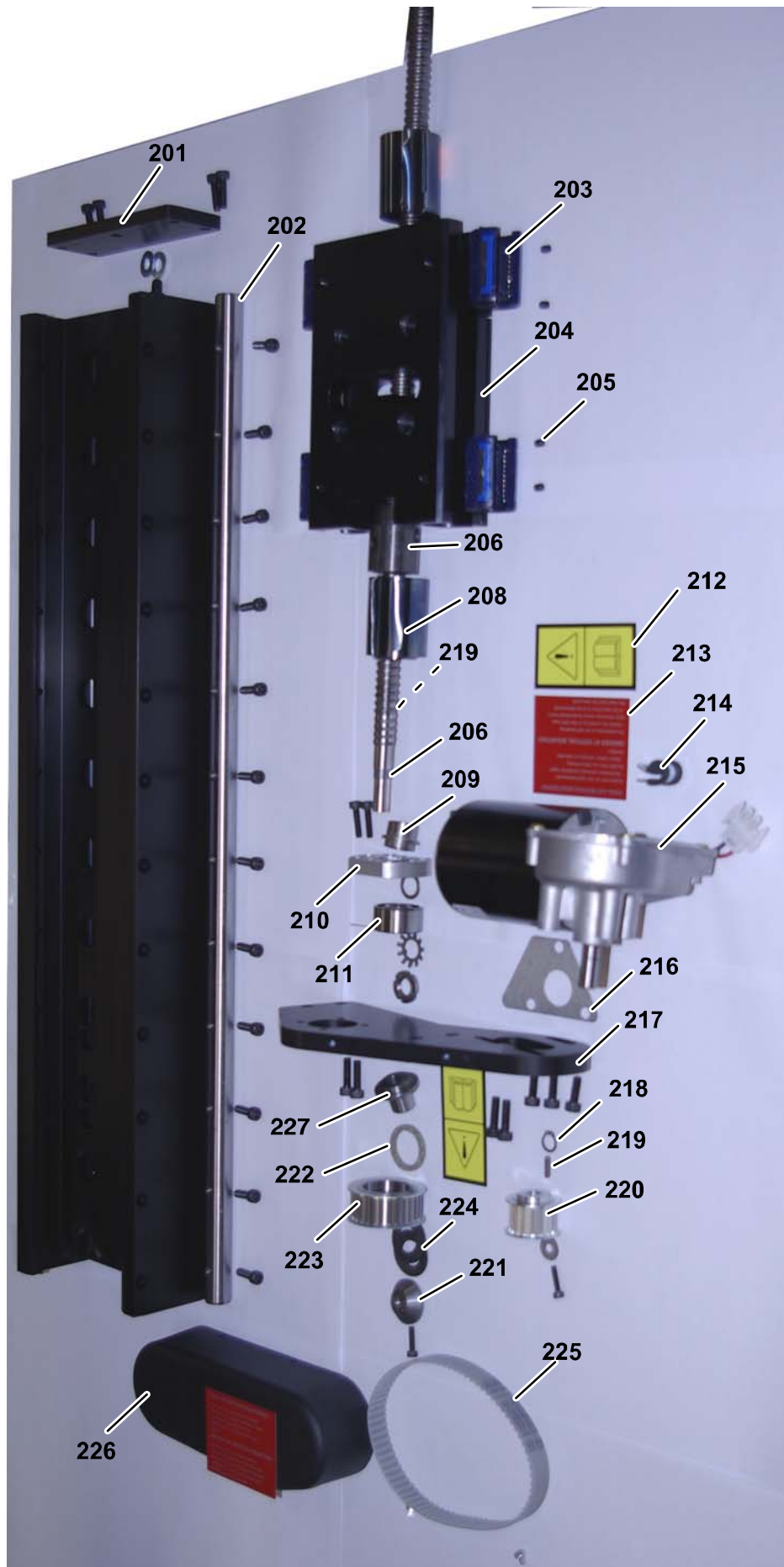

Slide

L= Setting lenght

Item	L=60	L=120	L=180	L=240	L=300	Ordering no.	Denomination	Notes
	940	941	942	943	944	0334 333	A6 Slide	
301	1	1	1	1	1	0461 221 001	End washer	
302	2	-	-	-	-	0334 323 001	Steel shaft	L=242.5
	-	2	-	-	-	0334 323 002	Steel shaft	L=302.5
	-	-	2	-	-	0334 323 003	Steel shaft	L=362.5
	-	-	-	2	-	0334 323 004	Steel shaft	L=422.5
	-	-	-	-	2	0334 323 005	Steel shaft	L=482.5
303	4	4	4	4	4	0334 337 001	Ball bushing open	2 sealed
304	1	1	1	1	1	0334 331 880	Runner for slide	
305	8	8	8	8	8	0190 509 321	Stop screw	M5x6
306	1	-	-	-	-	0334 332 001	Ball screw and nut	L216
	-	1	-	-	-	0334 332 002	Ball screw and nut	L276
	-	-	1	-	-	0334 332 003	Ball screw and nut	L336
	-	-	-	1	-	0334 332 004	Ball screw and nut	L396
	-	-	-	-	1	0334 332 005	Ball screw and nut	L392.5
307	2	2	-	-	-	0334 325 001	Bellow stearing	
	-	-	2	-	-	0334 325 003	Bellow stearing	
308	2	2	-	-	-	0333 441 002	Telescopic bellows	D30/20
	-	-	2	2	-	0333 441 005	Telescopic bellows	D35/20
	-	-	-	-	2	0156 726 003	Telescopic bellows	D40/20
309	1	1	1	1	1	0334 324 001	Bellow stearing	D=20
310	1	1	1	1	1	0154 457 002	Ball bearing cap	
311	1	1	1	1	1	0190 531 201	Bearing	SKF 3201
312	2	2	2	2	2	0443 719 001	Sign	
313	2	2	2	2	2	0334 472 001	Warning sign	
314	1	1	1	1	1	0417 699 002	Clamp	
315	1	1	1	1	1	0449 295 001	Drive unit	24V, with puls generator
316	1	1	1	1	1	0334 321 001	Washer	Cover plate
317	1	1	1	1	1	0461 223 001	Motor bracket	
318	1	1	1	1	1	0215 701 007	Circlip	D10
319	2	2	2	2	2	0215 701 209	Flat wedge	3x3x14
320	1	1	1	1	1	0334 328 002	Toothed pulley	z=19
321	1	1	1	1	1	0334 330 880	Compression washer complete	
322	1	1	1	1	1	0334 327 001	Friction ring	
323	1	1	1	1	1	0334 328 001	Toothed pulley	z=30
324	2	2	2	2	2	0219 504 411	Spring washer	D31.5 / 16x1.2
325	1	1	1	1	1	0334 342 001	Cog belt	L=400 / 80 T
326	1	1	1	1	1	0334 320 001	Belt guard	
327	1	1	1	1	1	0334 329 001	Friction pin	

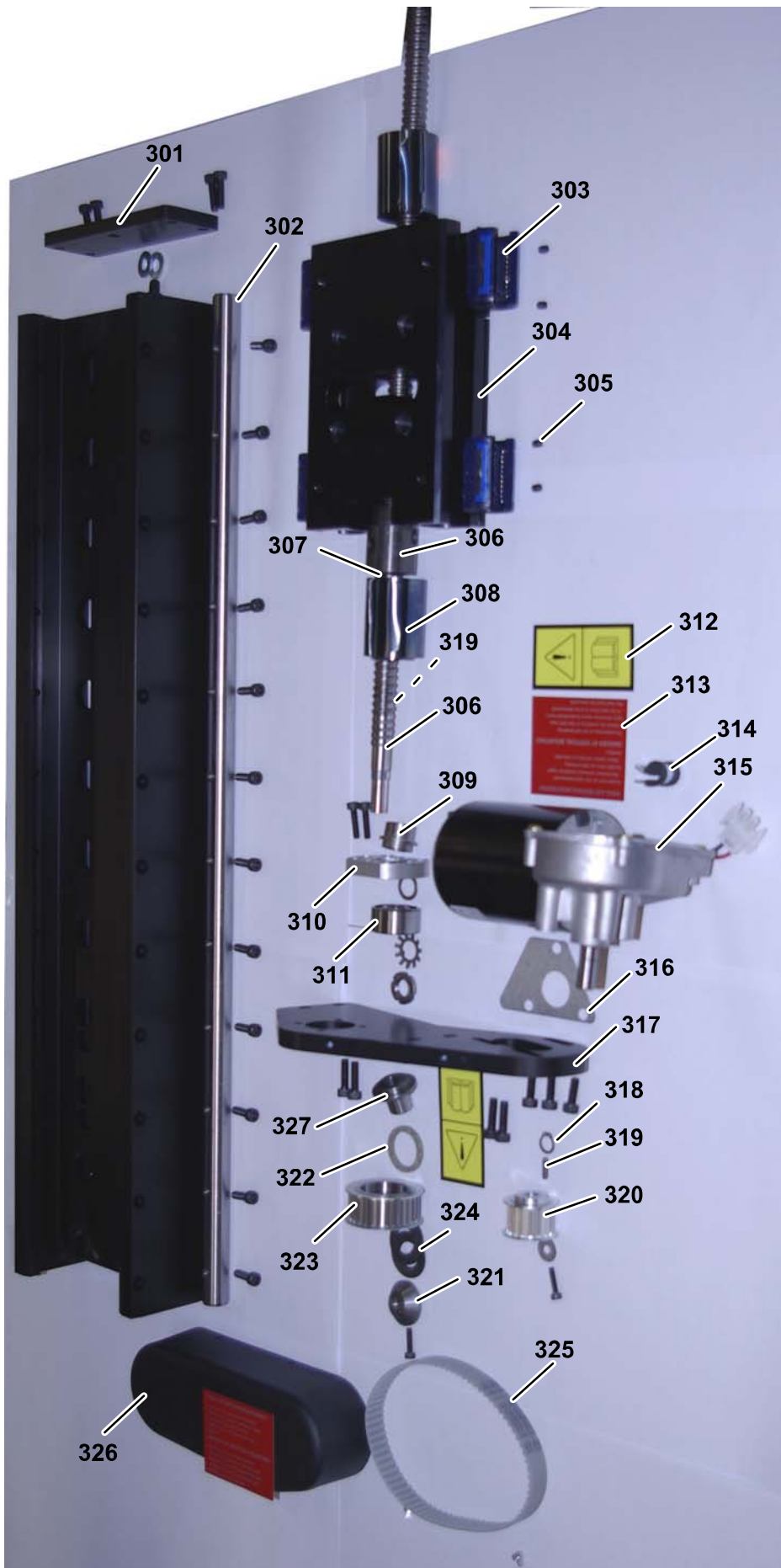

Slide

L= Setting lenght

Item	L=420	L=540	Ordering no.	Denomination	Notes
	945	946	0334 333	A6 Slide	
401	1	1	0461 221 001	End washer	
402	2	-	0334 323 006	Steel shaft	L=602.5
	-	2	0334 323 007	Steel shaft	L=722.5
403	4	4	0334 337 001	Ball bushing open	2 sealed
404	1	1	0334 331 880	Runner for slide	
405	8	8	0190 509 321	Stop screw	M5x6
406	1	-	0334 332 006	Ball screw and nut	L576
	-	1	0334 332 007	Ball screw and nut	L633.5
408	2	2	0156 726 003	Telescopic bellows	D40/20
409	1	1	0334 324 001	Bellow steering	D=20
410	1	1	0154 457 002	Ball bearing cap	
411	1	1	0190 531 201	Bearing	SKF 3201
412	2	2	0443 719 001	Sign	
413	2	2	0334 472 001	Warning sign	
414	1	1	0417 699 002	Clamp	
415	1	1	0449 295 001	Geared motor wit	24V, with puls generator
416	1	1	0334 321 001	Washer	
417	1	1	0461 223 001	Motor bracket	
418	1	1	0215 701 007	Circlip	D10
419	2	2	0215 701 209	Flat wedge	3x3x14
420	1	1	0334 328 002	Toothed pulley	z=19
421	1	1	0334 330 880	Compression washer comp.	
422	1	1	0334 327 001	Friction ring	
423	1	1	0334 328 001	Toothed pulley	z=30
424	2	2	0219 504 411	Spring washer	D31.5 / 16x1.2
425	1	1	0334 342 001	Cog belt	L=400 / 80 T
426	1	1	0334 320 001	Belt guard	
427	1	1	0334 329 001	Friction pin	

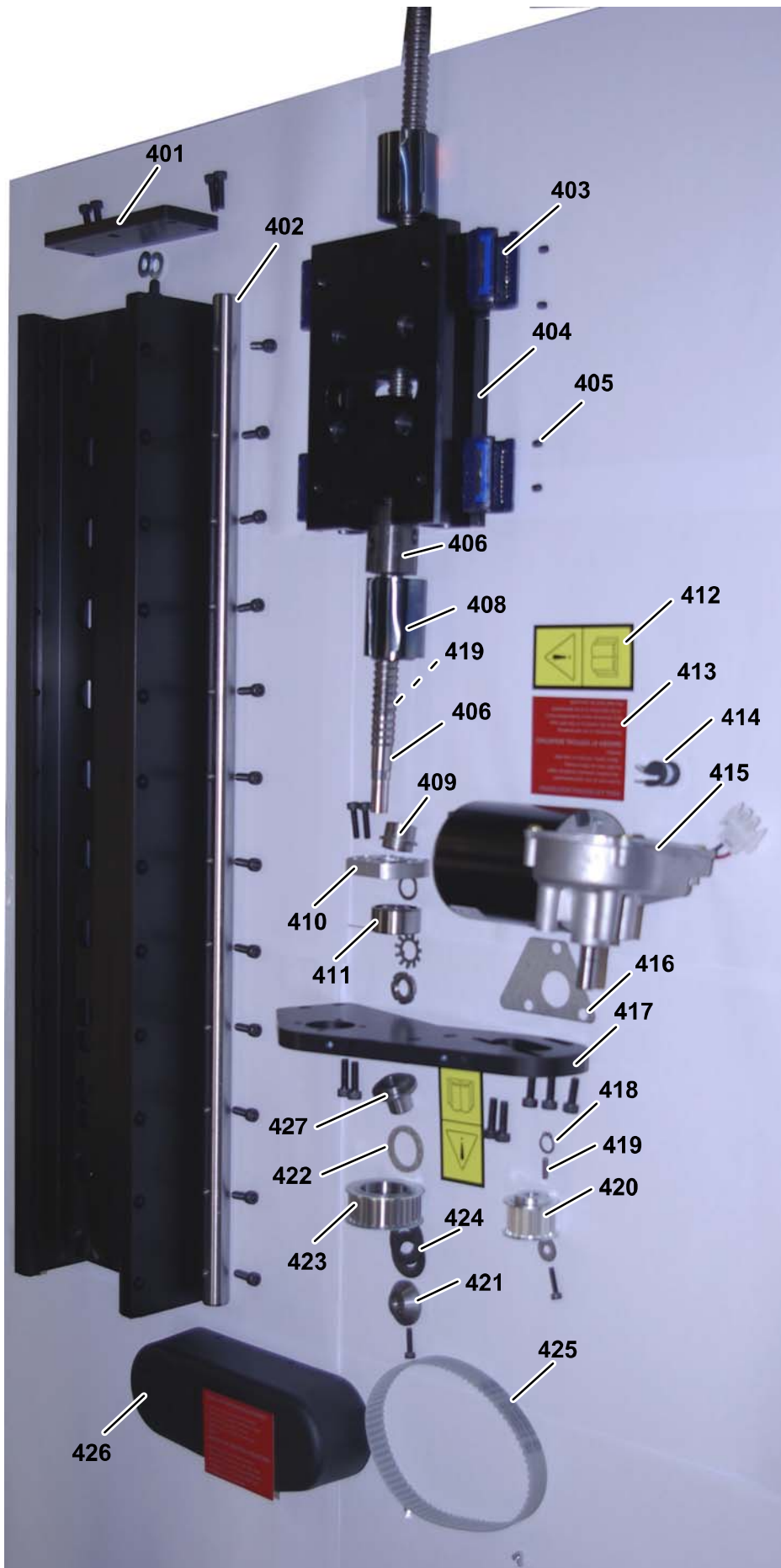

Slide

Wear parts

Ordering no.	Denomination	Notes
0334 342 001	Cog belt	L400 / 80T



Slide

Accessories

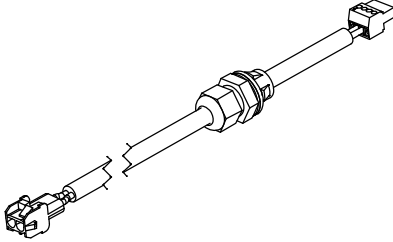
	Motor cable, A6 Slide - Control box A6 GMH, A6 PAV and A6 FAA	
	2 m	0460 745 880
	5 m	0460 745 881
	10 m	0460 745 882
	16 m	0460 745 883
	19 m	0460 745 884
	22 m	0460 745 885
	25 m	0460 745 886
	28 m	0460 745 887
	32 m	0460 745 888
	35 m	0460 745 889

