

Kühlart / Cooling method	Belastbarkeit [A] / Rating [A] / Mix (M21)	CO ₂	Einschaltdauer / Duty cycle (10 min.)	Draht-Ø / Wire diam. [mm]
Gas / gas	350	380	60 %	1.0 - 1.6

Typ / Type	Anschluss / Connector	Biegung / Bend	Art. Nummer / Part no.
TBI 6G	Euro	50°	165P3423_0*

Düsenstock / Tip holder

► M10 / L = 35 mm	342P010065
M8 / L = 38 mm	342P008065

Gasverteiler / Gas diffusers

► Schwarz / Black	130P002026
Keramik / Ceramic	130P002019

Stromdüsen / Contact tips

► M10x33, ECu	340P__1402*
M10x33, CuCrZr	343P__3402*
M8x30, ECu	340P__1262*
M8x30, CuCrZr	340P__3262*
M8x30 Alu, Ecu	341P__1262*

Gasdüsen / Gas nozzles



NW 16	NW 14	NW 19
345P022271	345P023171	345P021171

ESG kpl. / ESG cpl.

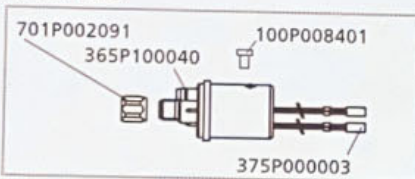

Griffschale kpl. / Handle cpl. kit

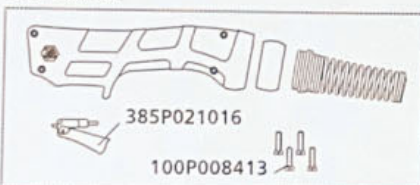

► Standard / Standard

*Bitte an Leerstelle entsprechende Angaben für Brennerlänge oder Drahtdurchmesser einsetzen, z.B. 08 für 0.8 mm oder 3 für 3 m.
At the blank, please insert suitable information for torch length or wire diameter, e.g. 08 for 0.8 mm or 3 for 3 m.

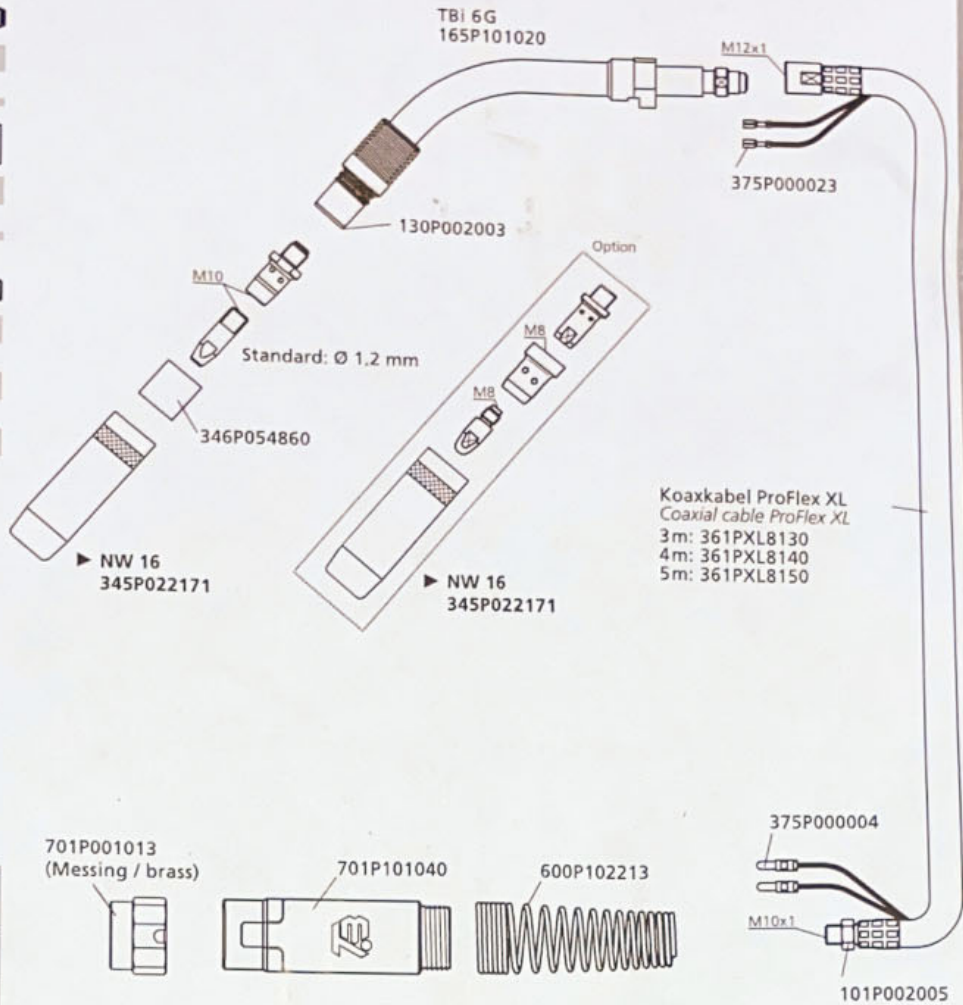

Koaxkabel ProFlex XL
Coaxial cable ProFlex XL
3m: 361PXL8130
4m: 361PXL8140
5m: 361PXL8150

701P001013 (Messing / brass)

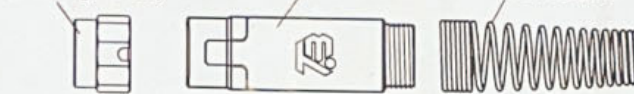

Drahtführungen / Wire guides

	m	Ø 0.8 - 1.0	Ø 1.0 - 1.2	Ø 1.2 - 1.6
Drahtführungsspirale für Stahldraht Liner for steel wire	3	—	rot / red	gelb / yellow
	4	—	324P204534	► 324P254534
	5	—	324P204544	► 324P254544
			324P204554	► 324P254554
PTFE-Seele für Alu- und Edelstahldraht PTFE liner for alu- and stainless steel wire	3	—	rot / red	gelb / yellow
	4	—	326P204035	326P274735
	5	—	326P204045	326P274745
			326P204055	326P274755
PA-Seele mit Bronzespirale für Aludraht PA liner with bronze liner for alu wire		anthrazit / anthracite		anthrazit / anthracite
	3	328P20403A	—	328P23473A
	4	328P20404A	—	328P23474A
	5	328P20405A	—	328P23475A