

ESAB P10 Welding Helmet

Passive Welding Helmet



ESAB P-10 Passive Shade 10 Welding Helmet

Welding Processes

- SMAW/MMA (Stick)
- GMAW (MIG/MAG)
- Flux Cored

The ESAB P10 welding helmet emulates the simple, classic design of a traditional welding helmet with modern features and performance.

The oversized passive shade DIN 10 filter is not only replaceable, it provides a wide viewing area allowing the user to weld with ease. The P10 also features a lightweight shell and adjustable ratcheting headgear that is easily customizable for all-day comfort.

There is no compromise when it comes to safety, and the ESAB P10 welding helmet is perfect for those seeking versatile, fixed shade welding protection.

- Large viewing area: 133 x 114 mm (5.25 x 4.5 in.)
- Filter thickness: 3mm (0.12 in.)
- Shade: DIN 10
- Easy-adjust ratcheting headgear
- Durable PP shell
- UV/IR protection: DIN 16

Visit **esab.com** for more information.



P10 passive helmet front view

ESAB P10 Welding Helmet

Specifications	
Viewing Area	133 x 114 mm (5.25 x 4.5 in.)
Passive Lens Shade	DIN 10
Standards and Certifications	ANSI: Z87.1 CSA: Z94.3
Weight	1.08 lbs (490 grams)

Ordering Information	
Description	Part Number
P10 Passive Shade 10 Welding Helmet	0700102052

Delivery includes: Ready-to-use P-10 Welding Helmet, Safety Manual

Spare Parts		
1	P10 replacement Shade 10 filter lens	0700102051

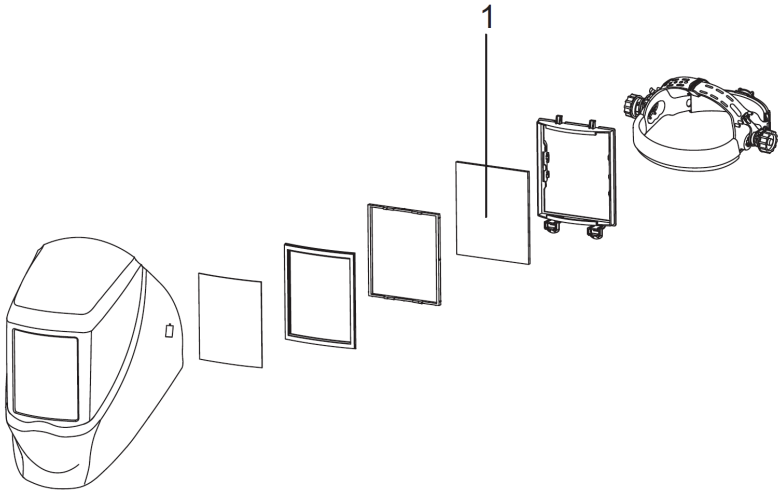

ESAB / [esab.com](https://www.esab.com)

